

Torggler



PRODUCT CATALOGUE

2023 Marine



PRODUCT CATALOGUE
2023 MARINE

Torggler S.r.l.

Via Prati Nuovi, 9
39020 Marlengo (BZ)
Italy

Tel.: +39 0473 282 400
info@torggler.com
www.torggler.com

VAT number
00851700211

IBAN
IT72 Y060 4558 5900 0000 0370 800

CONTENTS BY PRODUCT CATEGORY

01	PRIMERS AND CLEANERS	16
	Sitol® Primer Deck Caulking	18
	Cleaner for Polyurethane Foams	18
	Smooth	19
02	ADHESIVES	20
	Sitol® Marine	22
	Sitol® Deck Bonding	22
	Tack PU	23
	Strong	23
03	SEALANTS	24
	Sitol® Marine	26
	Sitol® Deck Caulking S	26
	Sitol® Deck Caulking	27
	Fire Resistant	27
	Heat Resistant	28
	Glass	28
	Neutral	28
	Domus	29
04	ADDITIONAL PRODUCTS	30
	Fire Resistant	32
	Epoxy	32
	Emulsione Epossidica 723	32

OVER 158 YEARS

- 200

Over 200 products.
Technical and highly professional
solutions through the highest
quality standards.

- 158

Over 158 years of history and
passion behind us, with one goal.
Being the professional partner for
professionals in the field.

- 43

The years of history of silicone and
acrylic sealants, formulated by our
laboratories and produced in our
factories.

- 150

150 professionals working at
Torggler every day. To give the best
in design, production and technical
support.

Torggler, a story of professionalism and passion.

Founded in South Tyrol in 1865, the company has always focused on research and development, becoming one of the most professional companies in the world of construction chemicals in Italy and abroad.

This experience has become an integral part of the offer to the market, with complete solutions and systems that always perform strongly, with stable results over time. Silicone, neutral and acetic sealants. Acrylic or hybrid polymer-based sealants. Polyurethane foams. Chemical anchors and systems for installing, restoring and finishing. A reliable and responsible partner which, in part due to a highly trained technical consulting service, can always provide a professional solution to any kind of professional need.

Torggler is not just a manufacturer, it is an idea. A concept of daily commitment, constant improvement of its skills and perseverance. A professional organization serving professionals in the field. Just like you.

A sustainable future

Today, a construction cannot be limited to being durable over time but the sustainability factor must be an integral part of the whole project. For more than 150 years we have been creating technologically advanced materials always thinking in terms of a system and not just a product to offer the opportunity to address the issue of durability and sustainability from a new and innovative point of view. Today more than yesterday. **Torggler. The solution.**



New in the industry, but not in quality

Our history of products and success in the world of sealing and bonding for over 40 years has prompted us to develop a new range of products for one of the sectors where materials are under the greatest stress: the marine industry.

Our R&D laboratories have taken on the challenge of the sea, formulating a new generation of hybrid polymers and silicones capable of withstanding all the critical conditions to which materials are subjected in the marine environment.



Sitol and the history of sealant

Today, as then, quality in the service of performance

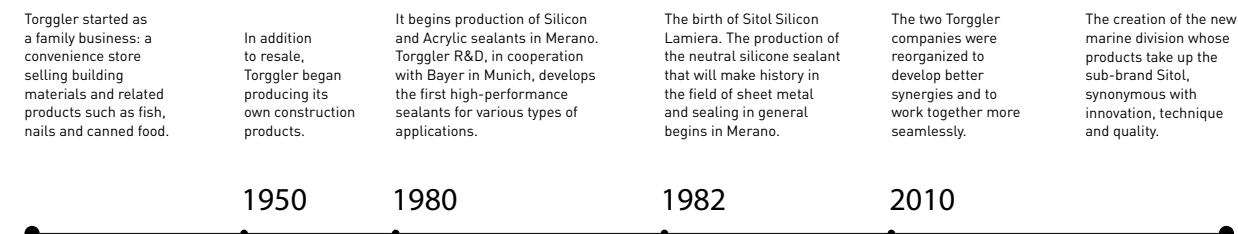

1865

2023



Product quality. Compliance with international requirements.

MED, Marine Equipment Directive, is final with Directive 2014/90/EU of the European Parliament and of the Council of 23 July 2014 on marine equipment and repealing Council Directive 96/98/EC and the term often refers to equipment approved according to the directive.

All devices intended for ships in the member states of the European Community are subject to MED approval and subsequent marking with the wheelmark, represented by a distinctive symbol in the shape of a ship's wheel. The objective of the directive is to improve safety at sea and prevent marine pollution through the uniform application of the relevant international instruments relating to marine equipment to be placed on board EU ships and to ensure the free movement of such equipment within the Union.

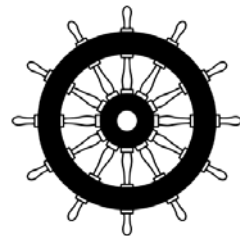

The IMO - International Maritime Organisation is a specialised agency of the United Nations - established following the adoption of the 1948 Geneva International Maritime Convention - to promote maritime cooperation among its member countries and to ensure the safety of navigation and the protection of the marine environment. The IMO is based in London and currently has 175 member countries, including Italy.

The development of standards takes place mainly on 4 different fields of action:

- SOLAS Convention whose main objective is to protect human life at sea.
- MARPOL Convention for the Prevention of Marine Pollution.
- STCW Convention for the Training and Certification of Maritime Personnel.
- Convention for the Development of Standards for the Coordination of Maritime Rescue (SAR).

It commonly applies to all ships operating on international routes, except in the following cases:

- Warships or troop carriers.
- Cargo ships of less than 500 t.
- Ships without mechanical propulsion equipment.
- Wooden ships of primitive construction.
- Pleasure ships not engaged in commercial traffic.
- Fishing vessels (which follow a specific regulation).

Safety in shipping is mainly covered by the SOLAS Convention, which stands for Safety of Life at Sea. It is an international (not exclusively European) Convention, issued by the IMO (International Maritime Organisation), the UN agency responsible for the safety of shipping and the prevention of marine pollution from ships. The Convention is structured in a series of Chapters and Rules that attempt to comprehensively address the various aspects of safety in a particular environment: the ship. The chapter that relates specifically to fire safety is II-2 "Construction - Fire protection, fire detection and fire extinction".

The above applies internationally, while in a more strictly European context, subject to common provisions, the instrument for their implementation is the MED Directive. The MED Directive was originally published in December 1996 with the aim of harmonising, for all EU Member States, conformity assessment procedures for equipment intended to be placed on board EU ships. It applies to passenger and cargo ships falling under the scope of international conventions, such as SOLAS.

The MED Directive covers the various categories of marine equipment in Annex A.1, which is subject to continual revision and updating for the inclusion of new products or the revision of regulatory instruments to verify their compliance. The equipment covered by the Directive, as is evident from the above, is covered by international regulations whose scope extends beyond the European scope. These are IMO or ISO standards, such as the FTP Code [Res. IMO MSC.61 (67)], which is more strictly concerned with fire protection. This Code, entitled "International Code for Application of Fire Test Procedures", contains the test methods and acceptance criteria for materials and components constituting the ship's structure and part of the furnishings (bulkheads, decks, fire doors and windows, upholstered furniture and bedding components, coating materials and curtains).



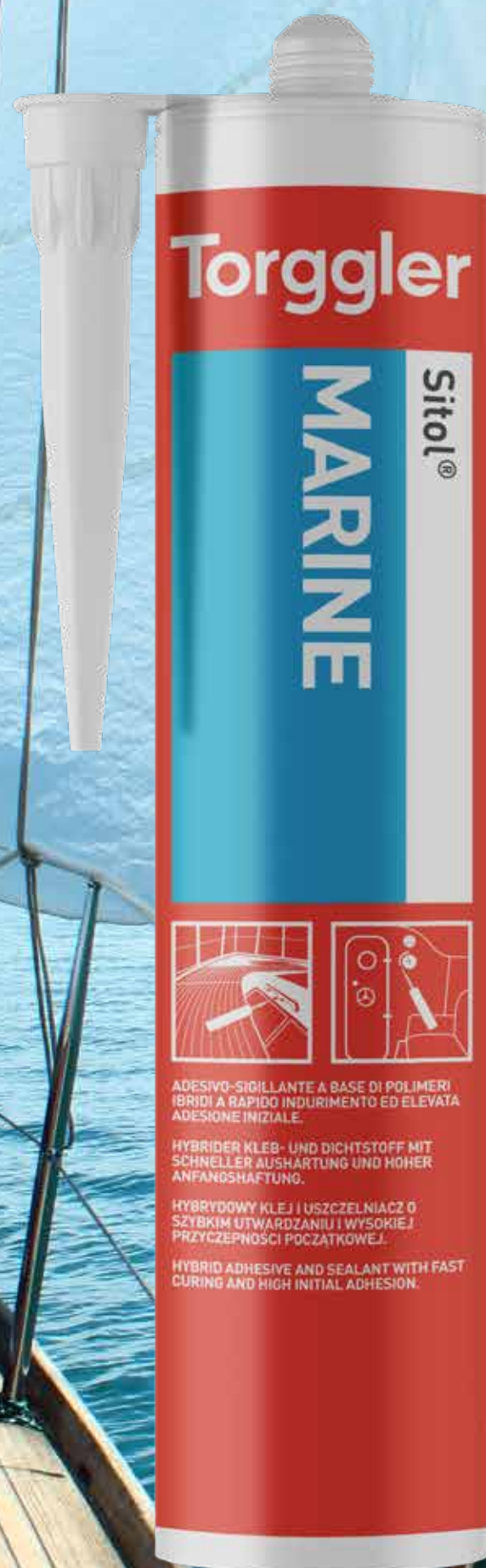

SITOL® MARINE

SIMPLE FOR EVERYTHING

Single-component, permanently elastic, fast-hardening, high initial adhesion, polymer-modified adhesive/sealant formulated for bonding and sealing applications on yachts and boats. IMO MED certified suitable for deck/hull and below deck applications on walls, floors and ceilings.

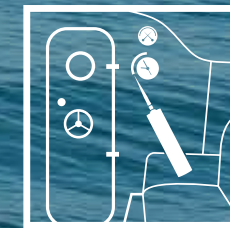
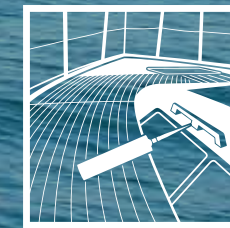



Areas of application:

1. Sitol Deck Bonding
2. Sitol Deck Caulking
3. Sitol Deck Caulking S
4. Tack PU
5. Sitol Marine
6. Silicone Glass
7. Silicone Domus
8. Silicone Heat Resistant
9. Silicone Fire Resistant
10. PU Foam Fire Resistant

Teak deck laying system

Instruction for application

1. BONDING



Prepare the surfaces where the deck will be bonded, regardless of whether they are smooth or porous and whatever their nature, so that they are clean, degreased and compact. For bonding teak planks, apply the adhesive in thin layer and full bed, with suitable toothed trowel, and bond before film forming. For bonding, the application temperature should be between +5 °C and +30 °C.



In the case of redoing old sealing, remove the old rubber mechanically with the help of a cutter or suitable tool. In the case of a new blanket, remove the excess adhesive in the seams after bonding.



Remove any residue with a vacuum cleaner or compressed air.



Sand the seams on both sides with 80-grit sandpaper using an appropriate tool.



The seams must be cleaned and restored to new wood.

2. SEALING



Teak wood feels "greasy" to the touch due to an oily-resinous component within it; this is the characteristic that gives teak excellent durability, even in environmental conditions usually hostile to wood. It is precisely because of this characteristic that teak is well resistant to moisture, salt, acids and attacks by insects and fungi. However, the presence of this oily resin can interfere with the adhesion of sealants and adhesives used for installing the planks and sealing the seams. This explains the importance of proper pretreatment with primer.



Make sure the rubber goes all the way to the bottom of the seam, allowing the rubber to slide upward until it reaches the top of the seam. Avoid starts and stops or changes in direction that can trap air.



Immediately after application, run a flexible squeegee over the seam at a 30-degree angle. Apply enough pressure so that the rubber penetrates the bottom of the seam, but leave an excess layer of rubber.



After application, ensure that no air has been trapped in the seams. Do not handle until completely hardened.



Allow the rubber to cross-link for at least 48 hours (more time is needed if temperatures are low) before trimming off excess sealant.



When the sealant is fully cross-linked, sand the deck surface to remove excess material with 80-grit sandpaper on soft substrate with an orbital sander.



Primers and cleaners

Pre-treatment is an integral part of an installation system.

The use of primers on the sides of seals, whether made on wood or porous material, improves the sealant adhesion. The sealing will perform better against physical and mechanical stresses, even under immersion.



SITOL® PRIMER DECK CAULKING

Liquid, solvent-based pre-treatment to improve adhesion on many porous substrates. Teak wood feels "greasy" to the touch due to an oily-resinous component within it; this is the characteristic that gives teak excellent durability, even in environmental conditions usually hostile to wood. It is precisely because of this characteristic that teak is well resistant to moisture, salt, acids and attacks by insects and fungi. However, the presence of this oily resin can interfere with the adhesion of sealants and adhesives used for installing the planks and sealing the seams. This explains the importance of proper pretreatment with primer.

Code	Details	Package	Pallets
5664	<div></div> Transparent	10 x 0.5 l	



CLEANER FOR POLYURETHANE FOAMS

Acetone-based cleaner suitable for cleaning substrates prior to priming or bonding. Thanks to its dual-system valve, it can be used both manually as a cleaner and mounted on polyurethane foam guns as a solvent.

Excellent and fast solvent power | Perfect work tool maintenance
| Cleaning of skirtings | Professional work

Code	Details	Package	Pallets
15010	-	12 x 500 ml	-



SMOOTH

Smoothing agent for professional surface finishing of connection joints and expansion joints made with silicone, acrylic, polyurethane and hybrid sealants.

Ready to use | Universal | Rapid cross-linking | Uniform hardening

Code	Details	Package	Pallets
5457	-	Bottle 8 x 750 ml	46 boxes



Adhesives

Adhesives specifically designed and tested for the marine industry where products must meet special adhesion strength requirements; weather and UV exposure, chemical aggression, permanent contact with salt water, extreme stresses and strains.



SITOL® MARINE

Single-component, permanently elastic, fast-hardening, high initial adhesion, polymer-modified adhesive - sealant formulated for bonding and sealing applications on yachts and boats.

Suitable for bonding and sealing in marine applications where adhesion and deformability must meet extreme requirements. Typical applications include:

- bonding and sealing of all deck accessories and equipment
- bonding of coatings on decks
- panels bonding and sealing
- deck-hull connections bonding and sealing
- hatches and portholes bonding
- as an adhesive for bonding decks (teak or artificial) and main decks in cases where a higher initial joining strength is required
- Bumper bonding
- Resistant to ageing and weather
- It bonds and seals in wet and immersed conditions
- Excellent adhesion without primer on all materials typical of the marine industry

IMO MED certified suitable for deck/hull and below deck applications on walls, floors and ceilings.



Code	Details	Package	Pallets
8328	<div></div> White	12 x 290 ml	130 boxes
8329	<div></div> Grey	12 x 290 ml	130 boxes
8330	<div></div> Black	12 x 290 ml	130 boxes



SITOL® DECK BONDING

Hybrid adhesive-sealant for bonding natural and synthetic teak and marine plywood panels to metal, polyester and wood. Permanently elastic from -30 to +100 °C, it absorbs vibrations and acoustically insulates bonded elements.

Good resistance to UV rays, ageing in general, chemicals and salt water | Does not shrink, does not crumble | Solvent- and isocyanate-free | Adheres to smooth and porous surfaces of any kind, even damp, provided they are clean, degreased and compact | Suitable for sealing between deck and teak, also synthetic

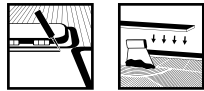

Code	Details	Package	Pallets
5663	<div></div> White	12 x 290 ml	116 boxes
5668	<div></div> White	20 x 600 ml	36 boxes



TACK PU

Single-component, solvent-free, hygro-hardening polyurethane paste adhesive, suitable for flexible bonding of wood, wood derivatives and various construction materials in the marine industry.

Thixotropic, suitable for vertical applications without dripping | Excellent resistance to water, temperature, weather and ageing according to EN 204 D4.



Code	Details	Package	Pallets
8327	<div></div> Ivory	12 x 310 ml	125 boxes



STRONG

Extra strong hybrid polymer-based adhesive with high initial adhesion. Does not require mechanical support during curing.

Paintable | Suitable for installing mirrors | Excellent adhesion on any surface, even wet ones | Quick and easy application without drilling the substrate

Consumption per meter Joint cross-section 15 x 3 mm: 45 ml
Linear meters made with one cartridge: 6.4

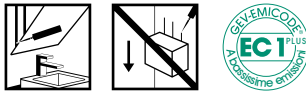

Code	Details	Package	Pallets
8007	<div></div> 105 White	12 x 290 ml	104 boxes



Sealants

Sealants in the marine industry are subjected to particular and extreme stresses, where exposure to UV rays, salt water, weather and chemical aggression are continuous.

Experience and technology have led us to a range of marine sealants that meets all the most stringent fields of application. Our products for sealing boast a unique success story of over 40 years.



SITOL® MARINE

Single-component, permanently elastic, fast-hardening, high initial adhesion, polymer-modified adhesive - sealant formulated for bonding and sealing applications on yachts and boats.

Suitable for bonding and sealing in marine applications where adhesion and deformability must meet extreme requirements. Typical applications include:

- bonding and sealing of all deck accessories and equipment
- bonding of coatings on decks
- panels bonding and sealing
- deck-hull connections bonding and sealing
- hatches and portholes bonding
- as an adhesive for bonding decks (teak or artificial) and main decks in cases where a higher initial joining strength is required
- Bumper bonding
- Resistant to ageing and weather
- It bonds and seals in wet and immersed conditions
- Excellent adhesion without primer on all materials typical of the marine industry

IMO MED certified suitable for deck/hull and below deck applications on walls, floors and ceilings.



Code	Details	Package	Pallets
8328	White	12 x 290 ml	130 boxes
8329	Grey	12 x 290 ml	130 boxes
8330	Black	12 x 290 ml	130 boxes



SITOL® DECK CAULKING S

Neutral silicone sealant for teak caulking, permanently elastic from -50 °C to +150 °C.

Excellent resistance to UV rays, ageing in general, chemicals and salt water | Does not shrink, does not crumble | Free of solvents and isocyanates | Adheres to smooth and porous surfaces of any kind as long as they are clean, degreased, dry and compact.



Code	Details	Package	Pallets
5660	Grey	24 x 290 ml	64 boxes
5661	Grey	20 x 600 ml	36 boxes



SITOL® DECK CAULKING

Hybrid sealant for teak caulking, permanently elastic from -40 to +100 °C.

Good resistance to UV rays, ageing in general, chemicals and salt water | Does not shrink, does not crumble | Solvent- and isocyanate-free | Adheres to smooth and porous surfaces of any kind, even damp, provided they are clean, degreased and compact | Also suitable for sealing between deck and synthetic teak

After properly preparing the seams and priming the sides of the teak, inject plenty of sealant. Apply light pressure with a trowel to eliminate gaps, if any, and improve adhesion on the sides. Wait for complete hardening before sanding flush.



Code	Details	Package	Pallets
5662	Black	24 x 290 ml	64 boxes



FIRE RESISTANT

Neutral cross-linking silicone sealant for sealing linear joints of fire walls and doors with fire resistance up to EI 240.

Low modulus of elasticity | UV and weather resistance | Twenty-year of tested effectiveness | Avoids the passage of smoke and flames in the escape routes

Certifications: F-EXT/INT-CC according to EN 15651-1
Certificate for the installation of window/door frames according to 11673-1
Consumption per linear metre Joint cross-section 10 x 10 mm: 100 ml
Linear meters made with one cartridge: 3.1



Code	Details	Package	Pallets
6766	237 Grey	24 x 310 ml	64 boxes



HEAT RESISTANT

Silicone sealant with acetic cross-linking, red,
with temperature resistance up to 300 °C.

High modulus of elasticity | Ideal for industrial applications
Fast hardening | Twenty years of tested effectiveness

Consumption per linear metre Joint cross-section 10 x 10 mm: 100 ml
Linear meters made with one cartridge: 3.1



Code		Details	Package	Pallets
6185		450 Red	24 x 310 ml	64 boxes

GLASS

Very low specific modulus of elasticity for joints on curtain walls and ventilated walls.

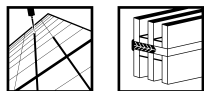

Code		Details	Package	Pallets
5594		215 Grey C1	24 x 310 ml	64 boxes
5595		290 Black	24 x 310 ml	64 boxes
5596		215 Grey C1	20 x 600 ml	36 boxes
5597		290 Black	20 x 600 ml	36 boxes

NEUTRAL

Transparent, neutral cross-linking silicone sealant
for sealing joints in general and in glazing.

Low modulus of elasticity | Fast hardening | UV and weather resistance
25% elastic elongation at high and low temperatures | Twenty years of tested effectiveness

Certifications: F-EXT/INT-CC 25LM; G-CC 20LM according to EN 15651-1,2
Certified for installation of window/door frames according to UNI 11673-1
Consumption per linear metre Joint cross-section 10 x 10 mm: 100 ml
Linear meters made with one cartridge: 3.1



Code		Details	Package	Pallets
6188		000 Transparent	24 x 310 ml	64 boxes
6523		000 Transparent	20 x 600 ml	36 boxes
6651		000 Transparent	20 l drum	-



DOMUS

Neutral curing silicone sealant with anti-mould agent and low modulus of
elasticity. In colour match with the Tile Grout line and wood shades.

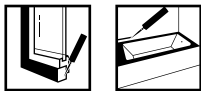

Code		Details	Package	Pallets
5603		000 Transparent	24x310 ml	64 boxes
5606		100 White 9010	24x310 ml	64 boxes
5607		105 White 9016	24x310 ml	64 boxes
5605		140 Ivory RAL 1013	24x310 ml	64 boxes
5608		210 Light grey	24x310 ml	64 boxes
5604		280 Anthracite RAL 7016	24x310 ml	64 boxes
5609		290 Black RAL 9005	24x310 ml	64 boxes
5615		250 Grey Metallic	12x310 ml	116 boxes
5621		376 Walnut	12x310 ml	116 boxes
5624		550 Green RAL 6005	12x310 ml	116 boxes
5617		150 Jasmin	12x310 ml	116 boxes
5618		200 Manhattan	12x310 ml	116 boxes
5616		205 Pearl Grey	12x310 ml	116 boxes
5614		230 Grey	12x310 ml	116 boxes
5623		310 Vanilla	12x310 ml	116 boxes
5610		320 Bahama	12x310 ml	116 boxes
5611		330 Beige	12x310 ml	116 boxes
5620		340 Hazelnut	12x310 ml	116 boxes
5619		350 Brown	12x310 ml	116 boxes
5613		360 Chocolate	12x310 ml	116 boxes
5622		370 Terracotta	12x310 ml	116 boxes
5612		380 Chestnut brown	12x310 ml	116 boxes



Additional products



FIRE RESISTANT

Polyurethane foam with high fire resistance for sealing and filling linear joints in situations subject to fire regulations up to class EI 120. Suitable for fixing junction boxes and electrical systems.

No need for additional material such as mineral wool or similar | Prevents the passage of smoke and flames into escape routes | Tested for ceiling applications | Twenty years of tested effectiveness

Certifications: Glow wire test at 850 °C
Yield in litres Free expansion: 41 l
Linear meters made with a spray can: 40 m



Code	Details	Package	Pallets
6911	Gun	12 x 750 ml	42 boxes
5533	Manual	12 x 750 ml	42 boxes



EPOXY

Two-component epoxy coating for the treatment and protection of bilges, engine compartments and peaks. It adheres perfectly to porous substrates such as fibreglass and wood and to all materials used in the marine industry such as stainless steel, aluminium and iron.

Solvent-free | It can also be applied at considerable thickness

Consumption: from 600 to 800 g/m².



Code	Details	Package	Pallets
5487	Grey	4 x 3 kg	-



EMULSIONE EPOSSIDICA 723

Two-component epoxy resin-based waterproofing paint in water emulsion, for waterproofing and chemical protection of mineral substrates.

Very high water repellency | Excellent breathability | Unaltered effectiveness over time

Consumption: 150 g/m² per application, by hand.
Total consumption: 400 - 800 g/m².



Code	Details	Package	Pallets
5482	Ivory	4 x 3 kg	-
5483	Grey	4 x 3 kg	-
5484	Red	4 x 3 kg	-



Torggler

Impresa dell'
ALTO ADIGE

Torggler S.r.l.

Via Prati Nuovi 9
I-39020 Marlengo (BZ)
Tel. +39 0473 282400
info@torggler.com

torggler.com



**Be green,
leave it on the screen.**

V1. 2023